

## JS18035 JOIST SUPPORT

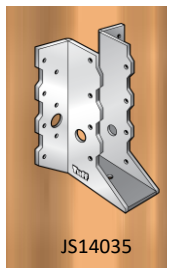
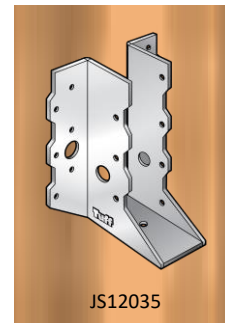
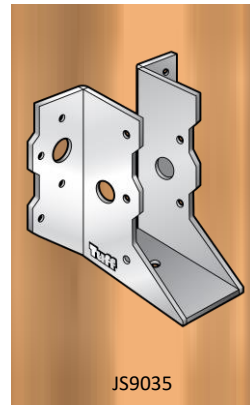
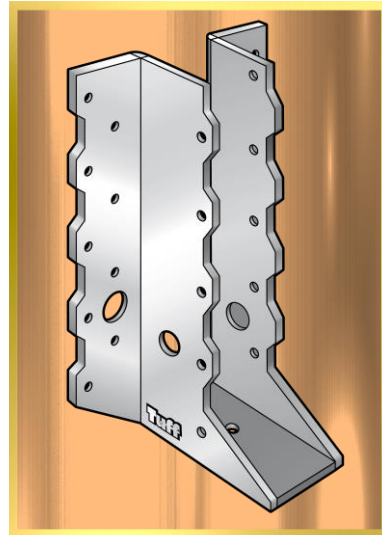

PRODUCT CODE	: JS18035
BARCODE	: 9314691806534
DIMENSION	: 180MM X 35MM
BOLT HOLE (LARGE)	: 12.8MM
BOLT HOLE (SMALL)	: 3.4MM
MADE FROM	: 1MM GALVANISED STEEL
GRADE	: G300 Z275

### NOTES:

- USED FOR TIMBER BEAM TO BEAM JOINTS
- THE WIDE RANGE AND SIZES OF THESE BRACKETS PROVIDE FOR ALL COMMON SIZED TIMBERS AND FOR LAMINATED TIMBER BEAMS
- THE JOIST SUPPORTS ARE STRONG, WELL DESIGNED, COST EFFECTIVE AND EASY TO INSTALL
- NAILED TO BOTH THE SUPPORTING BEAM AND THE SUPPORTED BEAM WITH THE JOIST SUPPORT HAVING WIDE FLANGES FOR EASE OF NAILING